

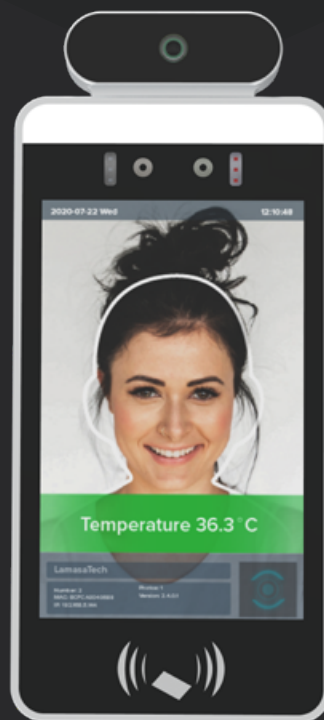

Temperature Measurement Kiosks with Facial Recognition

Industry-leading, automated personnel check-in kiosk.

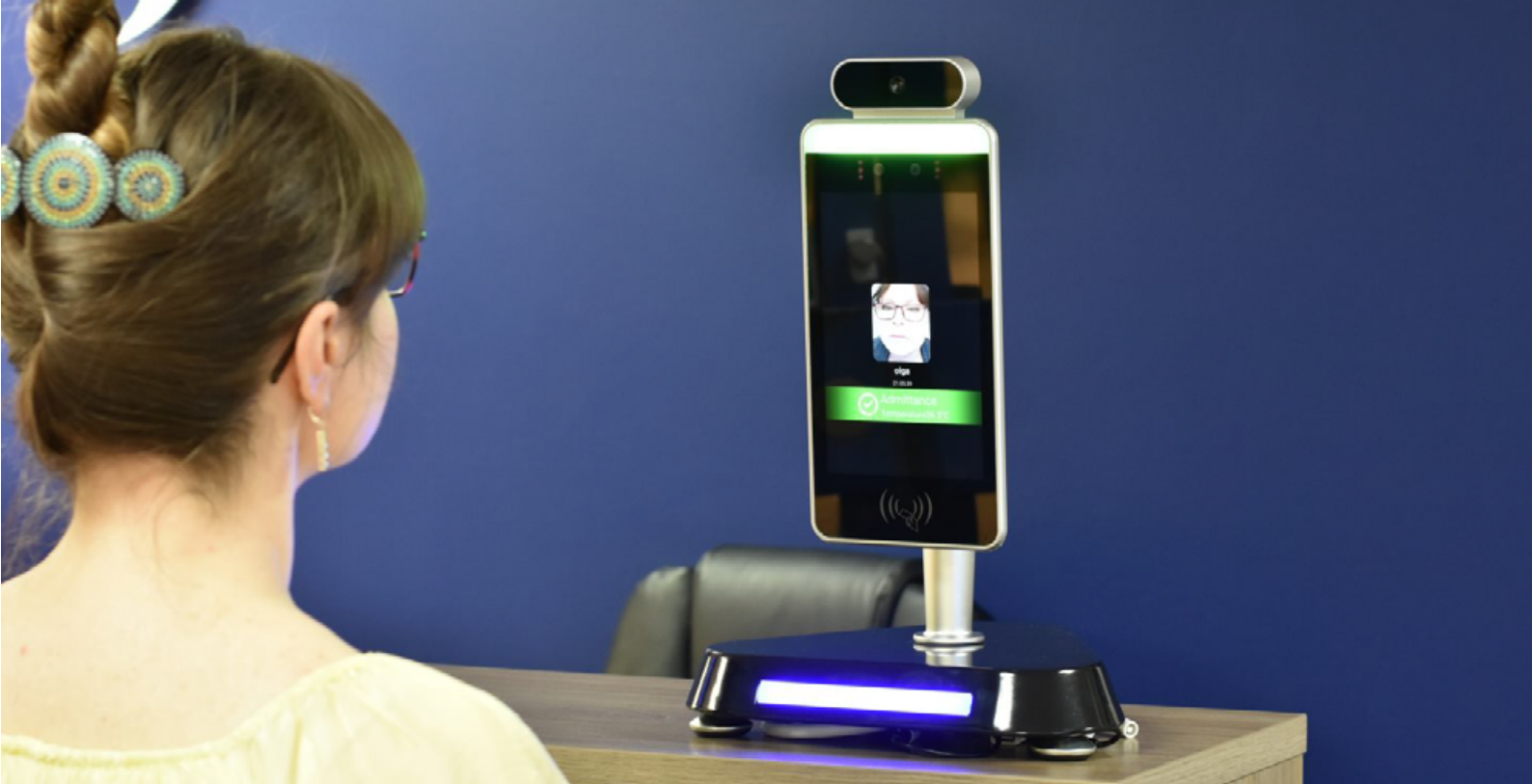



LamasaTech Temperature Kiosks

Non-contact kiosks automatically read body temperature in seconds, with optional facial recognition. These kiosks are designed to prevent virus spread and provide a safe environment for your employees, customers and visitors.

Screen all individuals before entry to public and private premises such as;



Office buildings



Supermarkets and grocery stores

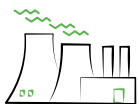

Manufacturing plants and factories



Hotels and airports



Healthcare settings

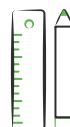

Schools



Retail stores and shopping malls



Universities

Key features of the Temperature Kiosk

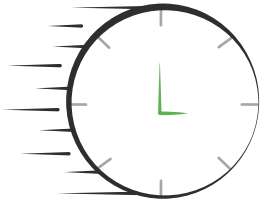

Reads temperatures
in ~ 1 second

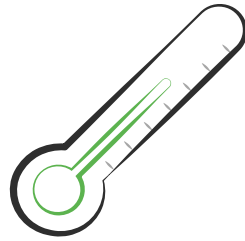

Verbal and on-screen
alerts for abnormal
temperature reading

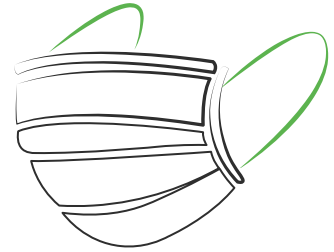

Optional mask detection

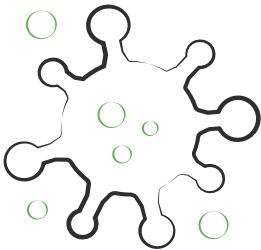

Helps to identify and
protect the workplace from
virus spread



Email alerts notifying
members of staff about high
temperatures



Optional ID badge
printing



Face ID

Optional facial recognition to
recognise and allow entry to
vetted individuals



1-year standard
warranty with optional
upgrade to lifetime warranty



Plug and play solution -
works standalone out of
the box with only power
required

Accurate temperature detection

- ✓ Reads temperature in ~ 1 second
- ✓ Top of the range German manufactured temperature sensor
- ✓ Marginal measurement error of $\pm 0.5^{\circ}\text{C}/\pm 0.9^{\circ}\text{F}$
- ✓ The recommended distance for the most accurate readings is 0.5 metres, with 1 metre being the furthest distance where temperature can be read
- ✓ Temperature threshold for abnormal temperatures is easily adapted in the application settings

Durable, commercial-grade hardware



- ✓ 8-inch IPS full-view LCD display
- ✓ Commercial-grade, waterproof and dust-proof design which is durable and reliable
- ✓ Built-in speakers provide audio alerts including warnings for abnormal temperatures and to request that users wear a mask
- ✓ Supports various peripheral expansions such as ID card reader, fingerprint reader, two-dimensional code reader etc.

Smart facial recognition

- ✓ Industrial-grade binocular wide dynamic camera, night infrared and LED dual photo flood lamp
- ✓ Face recognition speed is ~ 1 second
- ✓ Database capacity for 30,000 faces
- ✓ Supports recognition and comparison of faces with masks
- ✓ The 1:1 comparison recognition rate is more than 99.7%, the 1:N comparison recognition rate is more than 96.7% at a 0.1% misrecognition rate, and the live detection accuracy rate is 98.3% at a 1% mis rejection rate

Email alerts

The email alerts feature allows the system to send an email to a specified set of email addresses whenever a scan fails due to high temperature, no mask, or both.

ID badge printing

The badge printing feature allows the system to print a badge whenever a successful scan is completed. The criteria for when a badge is printed and what is displayed on the badge can be set in print badge settings.

In order to print badges, connect a Brother QL-800 printer to the kiosk via USB. The badges are designed to be printed on DK-2205 / DK-22205 continuous paper label rolls.

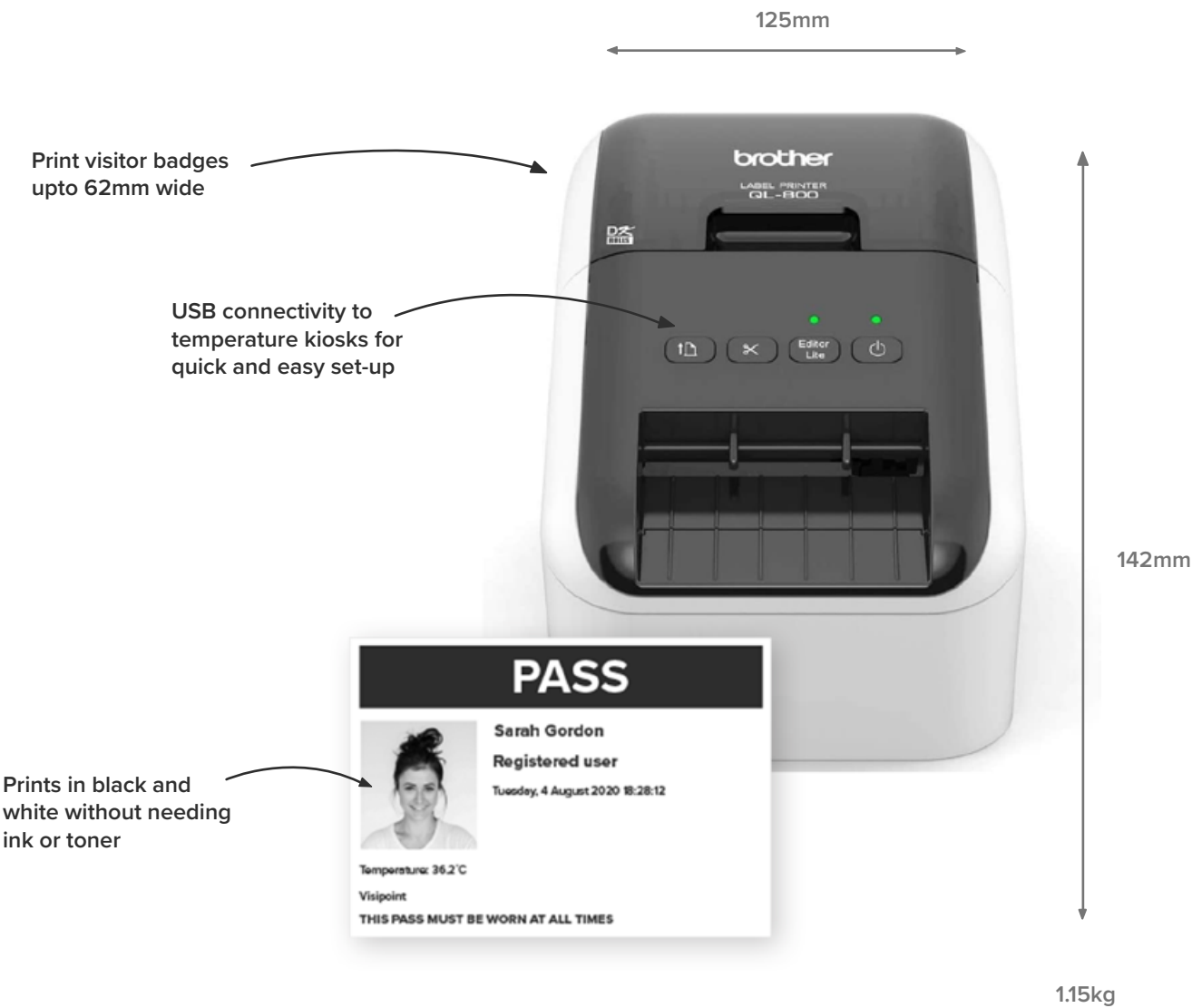

Mounting and Configuration

Mount the device onto an existing surface or select a desk stand, freestanding floor stand or wall mount.



LD-AITemp-DMKiosk

LD-AITemp-FMKiosk

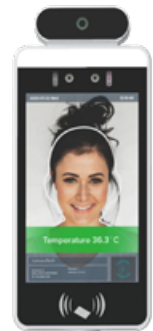

LD-AITemp-Device

LD-AITemp-WallDevice

Mounting Options

Turnstile Integration

Integrate the device with turnstile access using our dry relay connection, to allow turnstiles to open to staff and/or visitors that pass the acceptable temperature threshold.



Product Codes

Model Name	Product Code	Product No.	Product Notes
Temperature Pass Management & Face Recognition Surface Fixed Terminal	LD-AITemp-Device	7091135919162	Kiosk Device Only – On Pole To Be Mounted To Existing Surface
Temperature Pass Management & Face Recognition Wall Terminal	LD-AITemp-Wall Device	7091136435555	Kiosk Device With Wall Mount
Temperature Pass Management & Face Recognition Terminal on a Pedestal	LD-AITemp-FMKiosk	7091135919162-7091132058802	Kiosk Device With Freestanding Floor Mount
Temperature Pass Management & Face Recognition Terminal on a Desk Stand	LD-AITemp-DMKiosk	7091135919162-7091134419595	Kiosk Device With Portable Desktop Stand
Temperature Kiosk Pedestal Floor Mount	LD-AITemp-Floor-Mount	7091132058802	Freestanding Floor Mount Only
Temperature Kiosk Desktop Stand	LD-AITemp-Desk-Mount	7091134419595	Desktop Stand Only

Specifications

Model Temperature Pass Management Module & Face Recognition Kiosk

Camera

Resolution	2 million pixels
Type	Binocular wide dynamic camera
Aperture	F2.4
Focusing distance	50-150cm
White balance	Auto
Photo flood light	LED and IR dual photot flood light

Screen

Size	8.0 inch IPS LCD screen
Resolution	800x1280
Touch	Not supported (optional upgrade)

Processor

CPU	RK3288 quad-core (optional upgrades - RK3399 six-core, MSM8953 eight-core)
Storage	EMMC 8G

Interface

Network module	Ethernet and wireless (WIFI)
Audio	2.5W/4R Speakers
USB	1 USB OTG, 1 USB HOST standard A port
Serial Communication	1 RS232 Serial Port
Relay Output	1 Door open Signal Output
Wiegand	One Wiegand 26/34 output, one Wiegand 26/34 output.
Upgrade button	Support Uboot upgrade button
Wired network	1 RJ45 Ethernet socket

Function

Card reader	Upto 30,000
Face database library	Support
1:N face recognition	Support
1:1 face comaprison	Support
Stranger detection	Support
Identify distance	Support
configuration	Support

Function cont.

UI interface configuration	Support
Upgrade remotely Interface	Support Interfaces include device management and settings configuration, personnel/photo management, access and export of logs
Deployment method	Support public cloud deployment, privatised deployment, LAN use, standalone use.
Alerts feature	Email notifications with temperature readings.
ID badge printing	The badge printing feature allows the system to print a badge whenever a successful scan is completed.

Infrared Thermal Imaging Module

Temperature detection	Support – Optional feature which can be disabled if not required
Temperature detection distance	1 meter (optimal distance is 0.5 meter)
Temperature error rate	± 0.5°C, ± 0.9°F
Temperature measurement range	10°C ~ 42°C, 50 ~ 107.6°F
Thermal field of view	32° x 32°
Normal temperature confirmation	Support – Optional settings for verbal confirmation message and success light can be configured.
Abnormal temperature alarm	Support – Temperature threshold can be configured as well as optional settings for verbal warning message and warning light

General Parameters

Power	Input: 100-240V Output: 12V (±10%)
Operating temperature	0°C ~ 60°C, 32°F ~ 140°F
Storage temperature	-20°C ~ 60°C, -4°F ~ 140°F
Power Consumption	13.5W (max)
Installation method	4 configurations available – surface, wall mount, desktop stand mount, freestanding pedestal mount
Size	H260.18 x W132.88 x D25 (mm)

Packing list

Kiosk terminal (1), power adapter for your region (1), mount of choice (1)

Warranty and Support

Warranty period	1 year standard warranty
Warranty upgrade - Silver plan	Live chat support Ticket response within 2 business days
Warranty upgrade - Gold plan	Cloud server management to remotely manage devices and data Live chat support Ticket response within 1 business days Remote device management and updates
Warranty upgrade - Platinum plan	Cloud server management to remotely manage devices and data 24-hour live chat support Telephone support Ticket response within 1 business days Remote device management and updates 5% discount when you purchase additional devices LIFETIME hardware replacement. If the hardware is no longer in production, you get the next device in line at no extra cost
Technical support	Support via live chat, email and phone available

Cloud server deployment

Monitor logs and manage your facial database from the cloud. You can pull reports based on areas and monitor, configure and control your devices from the web application.

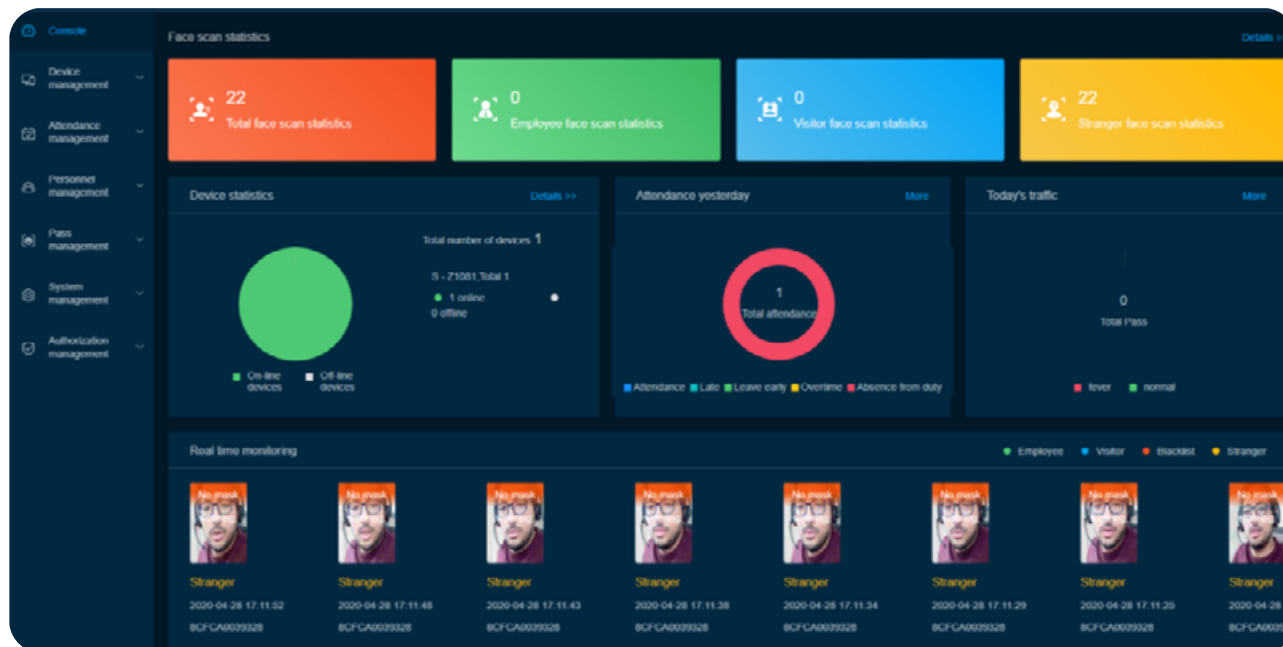

Pass management / Pass records

Refresh Export

Date: 2020-04-29 Status: All Traffic status: All Type of access: All Enter name or device name for fuzzy query

Snap photo	Name	ID	Body temperature	Pass status	Device name	Access direction	Creation time
	Joe Bob	Employee	36.8°C	Body temperature is normal.	BCFCA0039328	Face recognition	2020-04-29 22:47:04
	Joe Bob	Employee	36.5°C	Body temperature is normal.	BCFCA0039328	Face recognition	2020-04-29 22:48:58
	Joe Bob	Employee	36.2°C	Body temperature is normal.	BCFCA0039328	Face recognition	2020-04-29 22:48:55

Device management / Device list

Create +

Body temperature test Parameter settings Power control + More +

Device name: Enter keyword to query

Device name	Access type	Online status	Activation status	Version	IP address	MAC Address	Associate device groups	Operate
BCFCA0039328	Enter the gate	Online	Activated	2.3.9.3	192.168.50.18	BCFCA0039328	Attendance group	

1 total 10/Note/Page 5/1 1 Page Jump

Open the door remotely

Wire Interface Definition

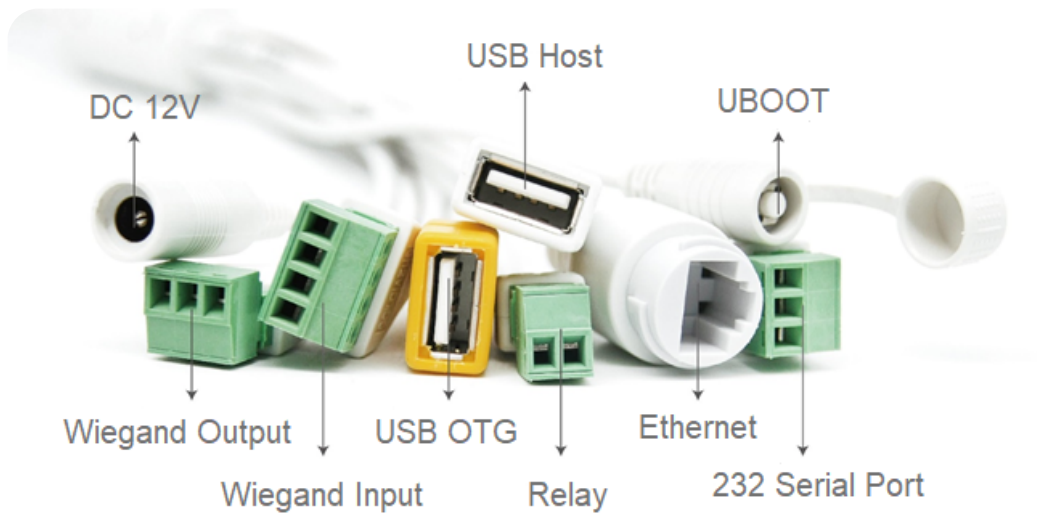

The interface of each terminal is defined as follows:

Relay	Terminal electrical definition
-------	--------------------------------

Pin 1	COM
-------	-----

Pin 1	N13O
-------	------

Wiegand Input	Terminal electrical definition
---------------	--------------------------------

Pin 1	D0_IN
-------	-------

Pin 2	D1_IN
-------	-------

Pin 3	12V
-------	-----

Pin 4	GND
-------	-----

Wiegand Output	Terminal electrical definition
----------------	--------------------------------

Pin 1	D0_OUT
-------	--------

Pin 2	D1_OUT
-------	--------

Pin 3	GND
-------	-----

232 Serial Port	Terminal electrical definition
-----------------	--------------------------------

Pin 1	232_RX1
-------	---------

Pin 2	232_TX1
-------	---------

Pin 3	GND
-------	-----

Technical Drawings

Wall mount

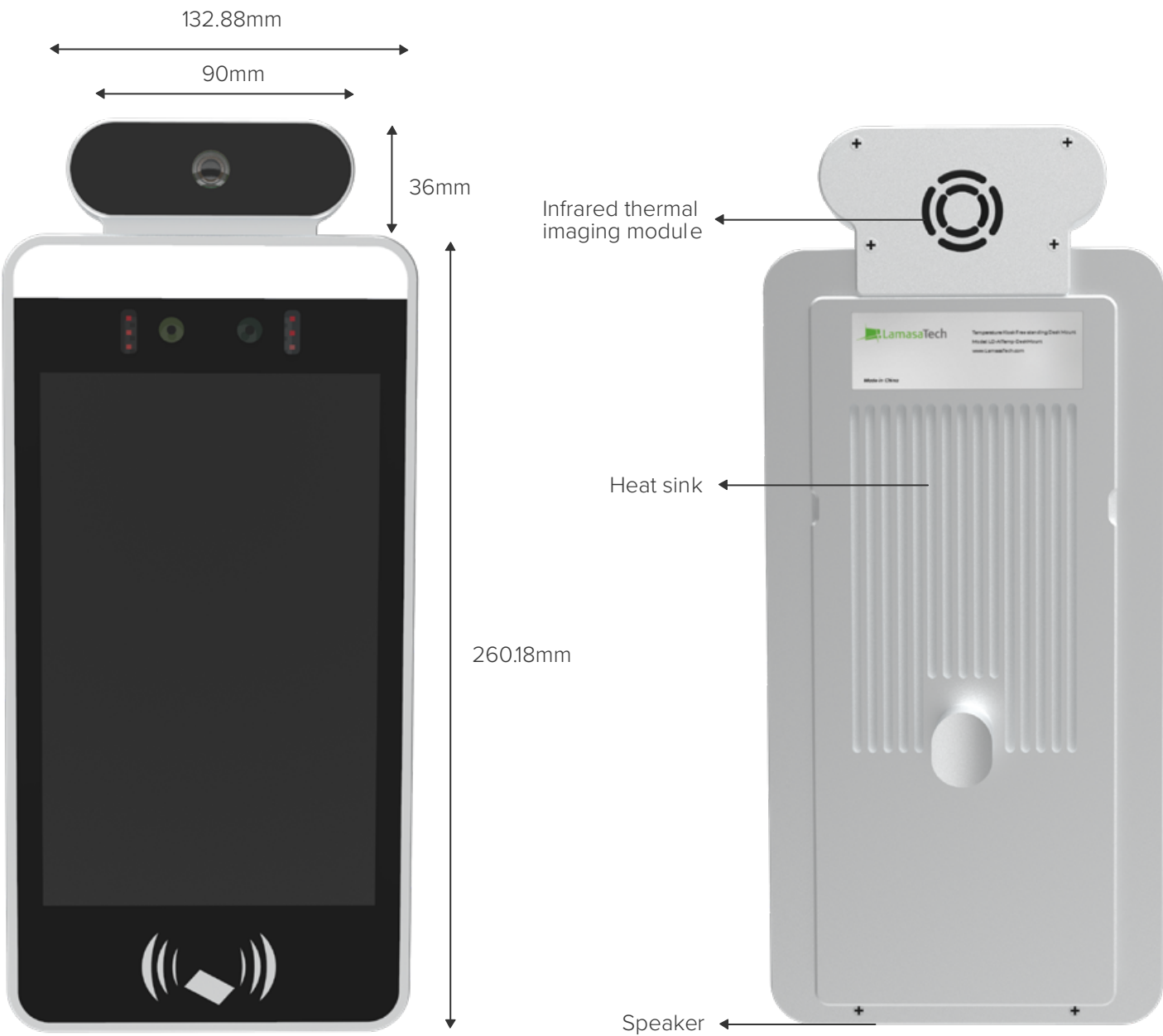

Technical Drawings

Desk Mount

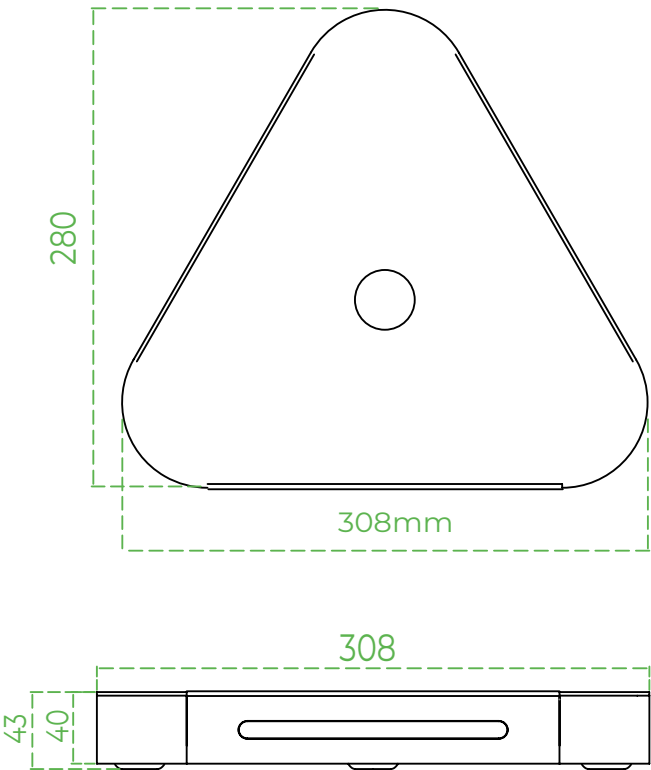

Technical Drawings

Surface Mount



Technical Drawings

Freestanding floor mount illustration

Front view

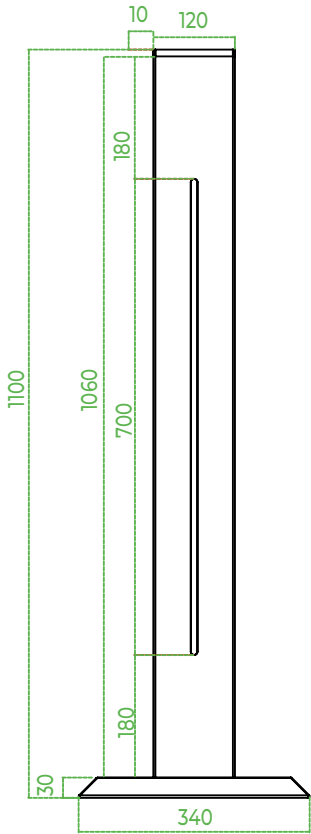

Side view

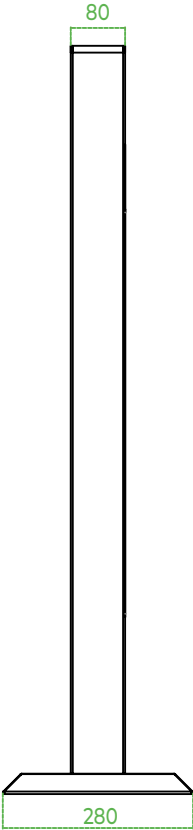



Contact us

UK: +44 (0) 191 341 0016

US: +1 (805) 308-9623

hello@lamasatech.com

lamasatech.com